

称重传感器 LOAD CELL

CM 称重传感器

CM Load Cell



- Maximum capacity (E_{max}) 额定载荷 (kg):
2,5,10,20,50,100,200,500,1000,2000,3000,5000

- Be suitable for a wide range of applications including testing or weighing systems, and it can be put into the device, in order to monitor the force.

适用力的控制及测量，更可装入仪器内部，以便对工作过程力进行监控

外形尺寸 Dimensions(in mm)

2kg...2000kg

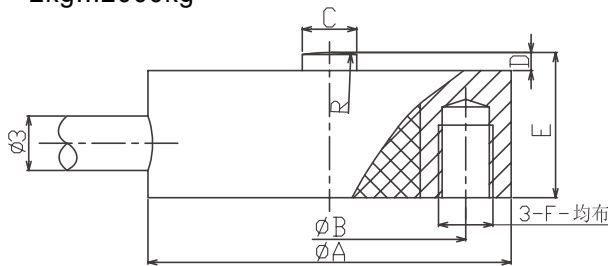

量程 Capacity(kg)	ØA	ØB	ØC	D	E	R	F
2-20	20	15	Ø3	1	8	10	M3dp4
50-200	20	15	Ø3	1	9	15	M3dp4
500-2000	25.4	18	Ø5	2	13	25	M4dp5

3t...5t

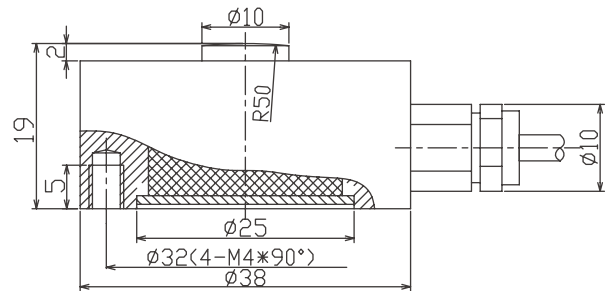

技术参数 Specifications

额定载荷 Rated Load	kg	2, 5, 10, 20, 50, 100, 200, 500
	t	1, 2, 3, 5
额定输出 Rated Output	mV/V	1~1.5±0.20
零点平衡 Zero Balance	%R.O.	±2
综合误差 Comprehensive Error	%R.O.	±0.3
蠕变 (30 分钟) Creep after 30 minutes	%R.O.	±0.05
推荐激励电压 Recommended excitation voltage	VDC	5-12 /15(max)
输入阻抗 Input impedance	Ω	350±5
输出阻抗 Output impedance	Ω	350±3
绝缘阻抗 Insulation resistance	MΩ	≥5000 (50VDC)
安全过载 Safe overload	%R.C.	150
极限过载 Ultimate overload	%R.C.	200
弹性元件材料 Material	Aluminum 铝合金 or Stainless steel 不锈钢	
防护等级 Degree of protection	IP65	